

DIMENSIONS

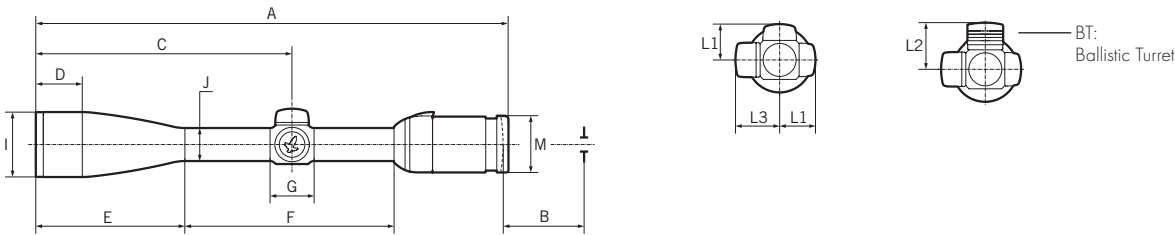

	Z5 2.4-12x50 (BT)	Z5 3.5-18x44 P (BT)	Z5 5-25x52 P (BT)	Z3 3-9x36	Z3 3-10x42	Z3 4-12x50 (BT)
A	334 mm/13.15 in	363 mm/14.29 in	371 mm/14.61 in	308 mm/12.13 in	321 mm/12.64 in	350 mm/13.78 in
B	95 mm/3.74 in	95 mm/3.74 in	95 mm/3.74 in	90 mm/3.54 in	90 mm/3.54 in	90 mm/3.54 in
C	170 mm/6.69 in	197 mm/7.76 in	205 mm/8.07 in	146 mm/5.75 in	160 mm/6.30 in	189 mm/7.44 in
D	36 mm/1.42 in	36 mm/1.42 in	39 mm/1.54 in	34 mm/1.34 in	35 mm/1.38 in	36 mm/1.42 in
E	99 mm/3.89 in	115 mm/4.53 in	122 mm/4.80 in	80 mm/3.15 in	97 mm/3.82 in	117 mm/4.61 in
F	149 mm/5.87 in	161 mm/6.34 in	162 mm/6.38 in	136 mm/5.35 in	135 mm/5.31 in	142 mm/5.59 in
G	34 mm/1.34 in	34 mm/1.34 in	34 mm/1.34 in	34 mm/1.34 in	34 mm/1.34 in	34 mm/1.34 in
I	56 mm/2.20 in	50 mm/1.97 in	58 mm/2.28 in	42 mm/1.65 in	48 mm/1.89 in	56 mm/2.20 in
J	25.4 mm/1.00 in	25.4 mm/1.00 in	25.4 mm/1.00 in	25.4 mm/1.00 in	25.4 mm/1.00 in	25.4 mm/1.00 in
L1	27 mm/1.06 in	27 mm/1.06 in	27 mm/1.06 in	27 mm/1.06 in	27 mm/1.06 in	27 mm/1.06 in
L2	37 mm/1.46 in	37 mm/1.46 in	37 mm/1.46 in	-	-	37 mm/1.46 in
L3	-	34 mm/1.34 in	34 mm/1.34 in	-	-	-
M	43 mm/1.69 in	43 mm/1.69 in	43 mm/1.69 in	40 mm/1.57 in	40 mm/1.57 in	40 mm/1.57 in
Objective filter thread	M 52x0.75	M 46x0.75	M 54x0.75	M 39x0.75	M 44x0.75	M 52x0.75

RETICLES

Z5

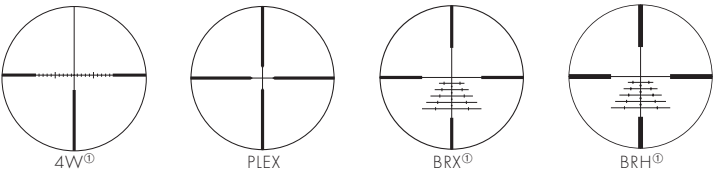

Z3

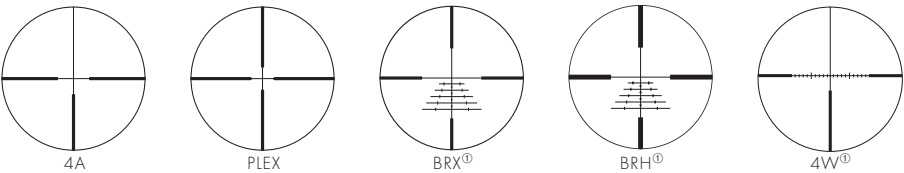

① See separate user manuals.



**SWAROVSKI
OPTIK**

SWAROVSKI OPTIK KG
6067 Absam, Austria
Tel. 00800/32425056
customerservice@swarovskioptik.com
Tel. 800-426-3089
info@swarovskioptik.us
SWAROVSKIOPTIK.COM

BA-696-02, 01/2019

Z5/Z3
SUBTENSION DIMENSION

SUBTENSION DIMENSIONS PROGRAM

The free subtension dimensions program allows you to quickly obtain all the precise subtension dimensions for your reticle for all SWAROVSKI OPTIK rifle scopes. These values can be calculated not only for all optional magnifications but also for different distances. All the calculated subtension dimensions are given in imperial or metric units, as well as in MOA and MIL units, and can be printed out afterwards.

A detailed description is available at SUBTENSIONS.SWAROVSKIOPTIK.COM

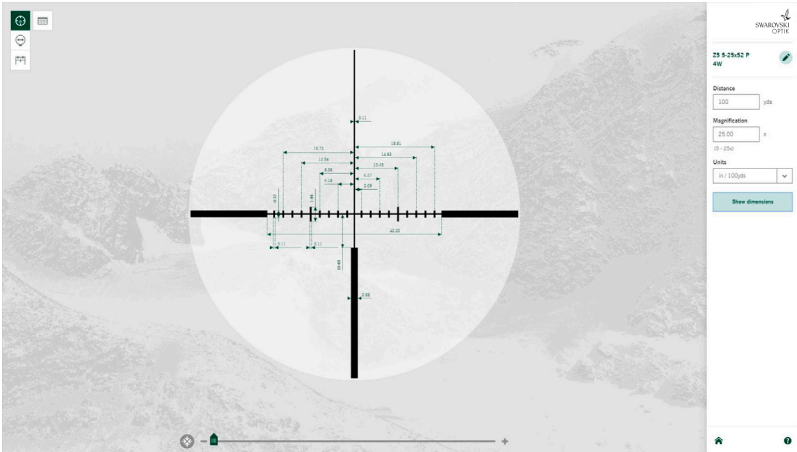

TECHNICAL DATA

Parallax-free at 109 yds/100 m · inert gas filling

Model	Z5 2.4-12x50 (BT)	Z5 3.5-18x44 P (BT)	Z5 5-25x52 P (BT)	Z3 3-9x36	Z3 3-10x42	Z3 4-12x50 (BT)
Magnification	2.4-12x	3.5-18x	5-25x	3-9x	3.3-10x	4-12x
Maintube diameter	25.4 mm/1 in	25.4 mm/1 in	25.4 mm/1 in	25.4 mm/1 in	25.4 mm/1 in	25.4 mm/1 in
Effective objective lens diameter	23-50 mm	35-44 mm	48-52 mm	36 mm	42 mm	50 mm
Exit pupil diameter	10-4.1 mm	10-2.4 mm	9.6-2.1 mm	12-4 mm	12.6-4.2 mm	12.5-4.2 mm
Exit pupil distance (Eye relief)	95 mm/3.74 in	95 mm/3.74 in	95 mm/3.74 in	90 mm/3.54 in	90 mm/3.54 in	90 mm/3.54 in
Field of view	15.3-3 m/100 m 45.9-9 ft/100 yds	10-2 m/100 m 30-6 ft/100 yds	7.3-1.5 m/100 m 21.9-4.5 ft/100 yds	13-4.5 m/100 m 39-13.5 ft/100 yds	11-3.9 m/100 m 33-11.7 ft/100 yds	9.7-3.3 m/100 m 29.1-9.9 ft/100 yds
Field of view (degrees)	8.7-1.75°	5.8-1.17°	4.2-0.84°	7.4-2.6°	6.3-2.2°	5.5-1.9°
Field of view, apparent (degrees)	21.5°	21.5°	21.5°	22.7°	22.7°	22.7°
Dioppter adjustment	-3 to +2 dpt	-3 to +2 dpt	-3 to +2 dpt	-2.5 to +2.5 dpt	-2.5 to +2.5 dpt	-2.5 to +2.5 dpt
Light transmission	92%	90%	90%	90%	90%	90%
Twilight factor based on ISO 14132-1	6.8-24.5	9.9-28.1	14.1-36	8.5-18	9.3-20.5	11.3-24.5
Impact point correction/click	7 mm/100 m 0.25 in/100 yds	7 mm/100 m 0.25 in/100 yds	7 mm/100 m 0.25 in/100 yds	7 mm/100 m 0.25 in/100 yds	7 mm/100 m 0.25 in/100 yds	7 mm/100 m 0.25 in/100 yds
Max. elevation/windage adjustment range	2.5/1.4 m/100 m 90/50 in/100 yds	1.6/1 m/100 m 58/36 in/100 yds	1.2/0.7 m/100 m 43/25 in/100 yds	1.6/1.6 m/100 m 58/58 in/100 yds	1.4/1.4 m/100 m 50/50 in/100 yds	1.2/1.2 m/100 m 43/43 in/100 yds
Parallax correction	100 m 109 yds	50-∞ m 55-∞ yds	50-∞ m 55-∞ yds	100 m 109 yds	100 m 109 yds	100 m 109 yds
Approx. length	334 mm/13.1 in	363 mm/14.29 in	371 mm/14.61 in	308 mm/12.13 in	321 mm/12.64 in	350 mm/13.78 in
Approx. weight	460 g 16.2 oz	450 g 15.9 oz	495 g 17.5 oz	340 g 12.0 oz	360 g 12.7 oz	410 g 14.5 oz
Functional temperature	-20/+55°C -4/+131°F	-20/+55°C -4/+131°F	-20/+55°C -4/+131°F	-20/+55°C -4/+131°F	-20/+55°C -4/+131°F	-20/+55°C -4/+131°F
Storage temperature	-30/+70°C -22/+158°F	-30/+70°C -22/+158°F	-30/+70°C -22/+158°F	-30/+70°C -22/+158°F	-30/+70°C -22/+158°F	-30/+70°C -22/+158°F
Waterproof to 4 m/13 ft nitrogen filled	0.4 bar	0.4 bar	0.4 bar	0.4 bar	0.4 bar	0.4 bar

Models with BRX/BRH reticle are set to be parallax free at 200 m/218 yds
L = light alloy for ring mounting BT = Ballistic Turret P = Parallax Turret

All the specifications given are typical values. We reserve the right to make changes regarding design and delivery. We accept no liability for printing errors.