

# MRAD

## ABDECKMASSE / SUBTENSION DIMENSION / COTES DE RECOUVREMENT / MISURE DEL RETICOLO / DIMENSIONES DE COBERTURA DE LAS RETÍCULAS / AFDEKMATEN / TÄCKMÅTT / TÄHTÄYSMITAT / AFDÆKNINGSMÅL / ПРОПОРЦИИ

### Determining distance to the target

You first must know the size of the target you are trying to determine distance to.

The following formula will work in metric or imperial:

$$\text{Distance in meter/yards} = \frac{(\text{known size of target in meter/yards} \times 1,000)}{\text{number of MILS covering the target}}$$

### Determining size of the target

You first must know the distance to the target in case you are trying to determine the size of it.

The following formula will work in metric or imperial:

$$\text{Size of the target} = \frac{(\text{distance to the target in meter/yards} \times \text{number of MILS covering the target})}{1,000}$$

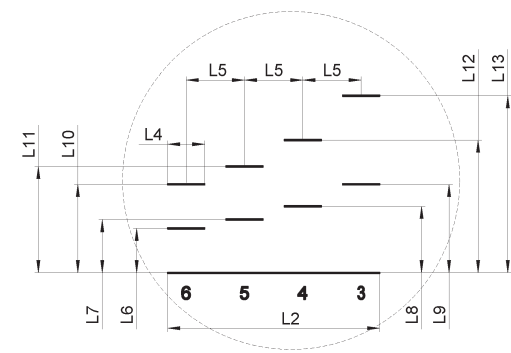
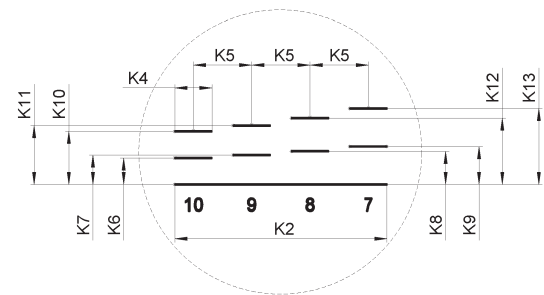
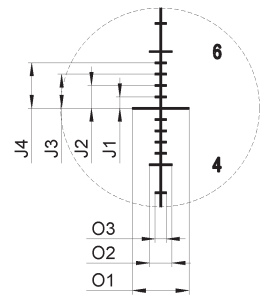
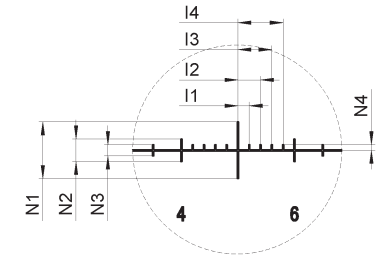
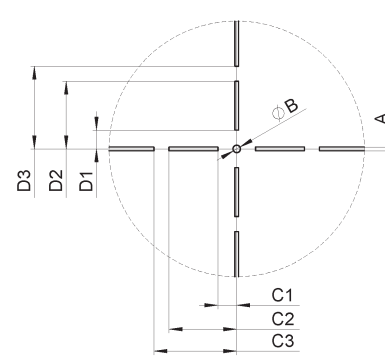
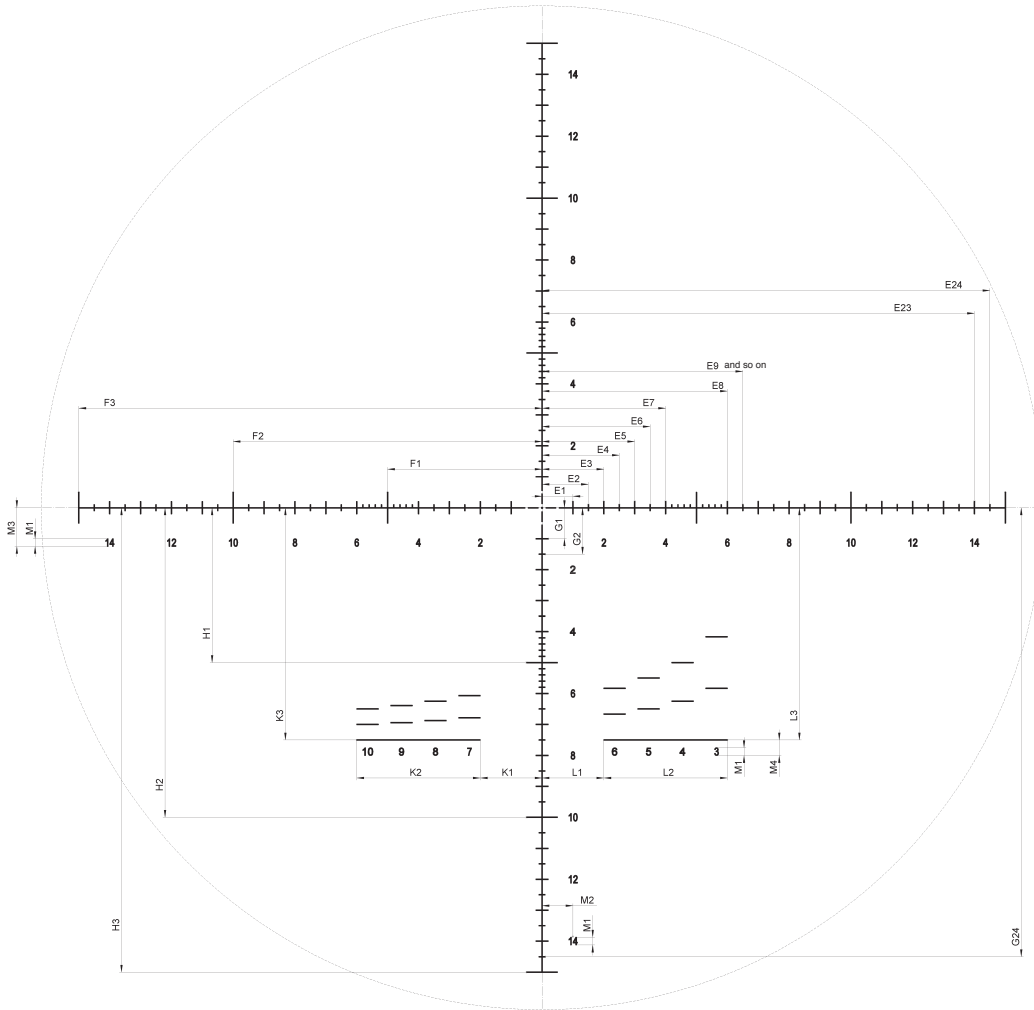

	MRAD	MOA	m/1,000 m	in/1,000 yds		MRAD	MOA	m/1,000 m	in/1,000 yds		MRAD	MOA	m/1,000 m	in/1,000 yds
A	0.03	0.10	0.03	1.08	E22 = G22	13.5	46.4	13.5	486	K10	1.0	3.4	1.0	36
B	0.05	0.20	0.05	1.8	E23 = G23	14.0	48.1	14.0	504	K11	1.1	3.8	1.1	40
C1	0.13	0.40	0.13	4.7	E24	14.5	49.9	14.5	522	K12	1.3	4.5	1.3	47
C2	0.45	1.50	0.45	16.2	F1	5.0	17.2	5.0	180	K13	1.4	4.8	1.4	50
C3	0.55	1.90	0.55	19.8	F2	10.0	34.4	10.0	360	L1	2.0	6.9	2.0	72
D1	0.13	0.40	0.13	4.7	F3	15.0	51.6	15.0	540	L2	4.0	13.8	4.0	144
D2	0.45	1.50	0.45	16.2	G1	1.0	3.4	1.0	36	L3	7.5	25.8	7.5	270
D3	0.55	1.90	0.55	19.8	G2	1.5	5.2	1.5	54	L4	0.7	2.4	0.7	25
E1	1.0	3.4	1.0	36	G24	14.5	49.9	14.5	522	L5	1.1	3.8	1.1	40
E2	1.5	5.2	1.5	54	H1	5.0	17.2	5.0	180	L6	0.8	2.8	0.8	29
E3 = G3	2.0	6.9	2.0	72	H2	10.0	34.4	10.0	360	L7	1.0	3.4	1.0	36
E4 = G4	2.5	8.6	2.5	90	H3	15.0	51.6	15.0	540	L8	1.3	4.5	1.3	47
E5 = G5	3.0	10.3	3.0	108	I1	0.2	0.7	0.2	7	L9	1.7	5.8	1.7	61
E6 = G6	3.5	12.0	3.5	126	I2	0.4	1.4	0.4	14	L10	1.7	5.8	1.7	61
E7 = G7	4.0	13.8	4.0	144	I3	0.6	2.1	0.6	22	L11	2.0	6.9	2.0	72
E8 = G8	6.0	20.6	6.0	216	I4	0.8	2.8	0.8	29	L12	2.5	8.6	2.5	90
E9 = G9	6.5	22.3	6.5	234	J1	0.2	0.7	0.2	7	L13	3.3	11.3	3.3	119
E10 = G10	7.0	24.1	7.0	252	J2	0.4	1.4	0.4	14	M1	0.3	1.0	0.3	11
E11 = G11	7.5	25.8	7.5	270	J3	0.6	2.1	0.6	22	M2	1.0	3.4	1.0	36
E12 = G12	8.0	27.5	8.0	288	J4	0.8	2.8	0.8	29	M3	1.3	4.5	1.3	47
E13 = G13	8.5	29.2	8.5	306	K1	2.0	6.9	2.0	72	M4	0.5	1.7	0.5	18
E14 = G14	9.0	30.9	9.0	324	K2	4.0	13.8	4.0	144	N1	1.0	3.4	1.0	36
E15 = G15	9.5	32.7	9.5	342	K3	7.5	25.8	7.5	270	N2	0.4	1.4	0.4	14.4
E16 = G16	10.5	36.1	10.5	378	K4	0.7	2.4	0.7	25	N3	0.2	0.7	0.2	7.2
E17 = G17	11.0	37.8	11.0	396	K5	1.1	3.8	1.1	40	N4	0.1	0.3	0.1	3.6
E18 = G18	11.5	39.5	11.5	414	K6	0.5	1.7	0.5	18	O1	1.0	3.4	1.0	36
E19 = G19	12.0	41.3	12.0	432	K7	0.6	2.1	0.6	22	O2	0.4	1.4	0.4	14.4
E20 = G20	12.5	43.0	12.5	450	K8	0.6	2.1	0.6	22	O3	0.2	0.7	0.2	7.2
E21 = G21	13.0	44.7	13.0	468	K9	0.7	2.4	0.7	25					

Alle Angaben sind typische Werte. Änderungen in Ausführung und Lieferung sowie Druckfehler sind vorbehalten.

All data are typical values. We reserve the right to make changes regarding design and delivery. We accept no liability for printing errors.

Toutes les données sont des valeurs standard. Sous réserve de modifications ultérieures concernant la conception, la livraison et les erreurs d'impression.

Tutti i dati riportati sono valori tipici. Con la riserva di apportare modifiche a modelli e forniture e salvo errori di stampa.

Todos los datos están indicados en valores medios. Queda reservado el derecho a introducir modificaciones en diseño y entrega. No aceptamos responsabilidad alguna por errores de impresión.

Alle gegevens zijn typische waarden. Wijzigingen in uitvoering en levering alsmede drukfouten voorbehouden.

Alla uppgifter är typiska värden. Ändringar i utförande och leverans samt tryckfel förbehålles.

Kaikki tiedot ovat yleisarvoja. Oikeudet muutoksiin mukaan lukien painovirheisiin pidätetään.

Alle angivelser er typiske værdier. Ret til ændringer mht. udførelse og levering samt trykfejl forbeholdes.

Все параметры являются типовыми. Производитель оставляет за собой право изменять конструкцию и комплект поставки, он не несет ответственности за возможные опечатки.